

Ledinaire Panel
RC065B

Scan me!
DOWNLOAD

	IP	IK	L×W×H1 (mm)	
RC065B G5 34S/840 PSU W60L60 OC CFW	IP40/IP20	IK02	595x595x35	1.65
RC065B G5 34S/865 PSU W60L60 OC CFW	IP40/IP20	IK02	595x595x35	1.65
RC065B G5 34S/840 PSU W60L60 NOC CFW	IP40/IP20	IK02	595x595x34	1.35
RC065B G5 34S/865 PSU W60L60 NOC CFW	IP40/IP20	IK02	595x595x34	1.35
RC065B G5 34S/840 PSD W60L60 OC CFW	IP40/IP20	IK02	595x595x35	1.65
RC065B G5 41S/840 PSU W60L60 NOC CFW	IP40/IP20	IK02	595x595x34	1.35
RC065B G5 41S/840 PSU W60L60 OC CFW	IP40/IP20	IK02	595x595x35	1.65
RC065B G5 60S/840 PSU 60x120 NOC TPb CFW	IP40/IP20	IK02	1195x595x34	3.2
RC065B G5 34S/840 PSU W60L60 OC Tpa CFW	IP40/IP20	IK02	595x595x35	1.65

Energy efficiency class of light source
D

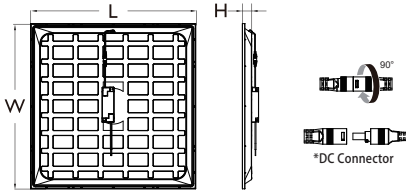

VPC visible profile ceiling

SP suspended

SM surface mounted

PCV plaster ceiling

Available as accessory (Need to purchase separately)

Suspension set:
911401809487: RC159Z Suspension set SME-3 WH
911401809387: RC159Z Suspension set SME-4 WH

Plaster set:
911401809287: RC159Z Plaster Ceiling SMB-PLC

Safety cable:
911401809187: RC159Z Safety Cable

Surface mounted set:
911401808087: RC059Z SMB W60L60
911401808187: RC059Z SMB W62L62
911401808287: RC059Z SMB W30L120

Surface mounted set:
911401807787: RC159Z SMB W60L60
911401807887: RC159Z SMB W62L62
911401807987: RC159Z SMB W30L120

Power Connection

Flying wires (CFW)

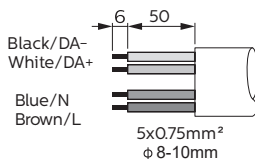
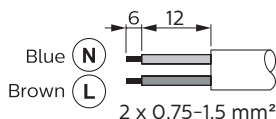

PSD Touch & Dim

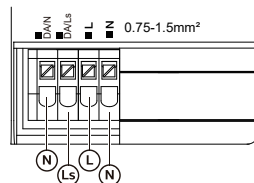

A Visible Profile Ceiling mounting(VPC) - Lay-In mounting

Install safety cable
(Optional)

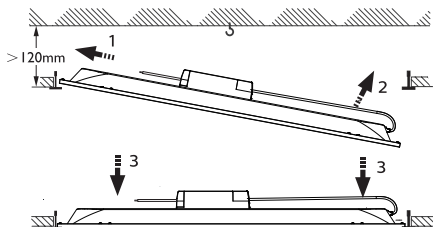
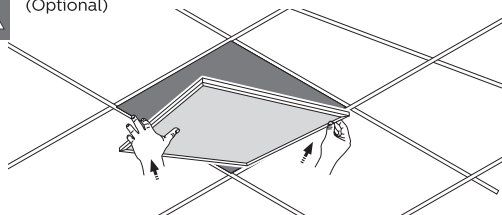

D Safety cable(SC)

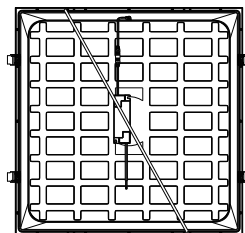
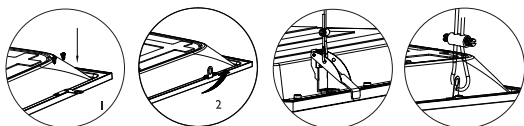
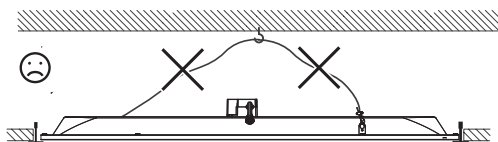
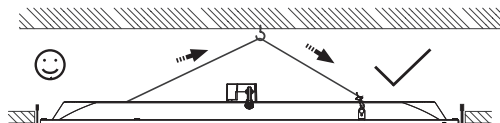

Inrush current

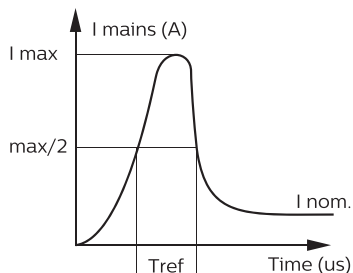

28W 28W 34W 50W PSU PSD

Electrical characteristics

I _{max} (A)	18.7	25.8	17.6	24
T _{ref} (μs)	218	255	217	230
MCB	Luminaires Max.			
B-10 A	13	9	18	7
B-13 A	18	13	24	10
B-16 A	23	17	30	13
C-10 A	24	17	31	11
C-13 A	32	23	42	15
C-16 A	39	28	52	19