

PANEL ECO HLO 600

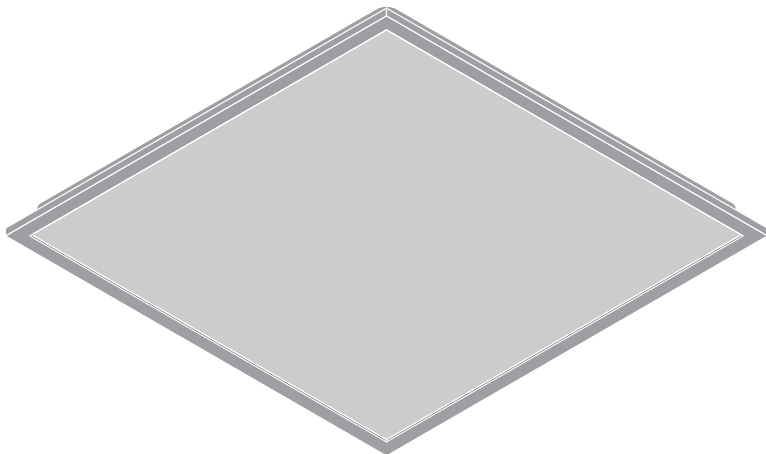

	EAN	Ø x h [mm]	W	V _{AC}	Hz	lm	lm/W	K
PL ECO HLO 600 E 34W 830	4099854187353	595x595x32	34	220-240	50/60	4080	120	3000
PL ECO HLO 600 E 34W 840	4099854187377	595x595x32	34	220-240	50/60	4080	120	4000
PL ECO HLO 600 E 34W 865	4099854187391	595x595x32	34	220-240	50/60	4080	120	6500
PL ECO HLO 600 E 34W 830 U19	4099854187414	595x595x32	34	220-240	50/60	3944	116	3000
PL ECO HLO 600 E 34W 840 U19	4099854187438	595x595x32	34	220-240	50/60	3944	116	4000
PL ECO HLO 600 E 34W 865 U19	4099854187452	595x595x32	34	220-240	50/60	3944	116	6500
PL ECO HLO 600 E 40W 830	4099854187476	595x595x32	40	220-240	50/60	4800	120	3000
PL ECO HLO 600 E 40W 840	4099854187490	595x595x32	40	220-240	50/60	4800	120	4000
PL ECO HLO 600 E 40W 865	4099854187513	595x595x32	40	220-240	50/60	4800	120	6500
PL ECO HLO 600 E 40W 830 U19	4099854187537	595x595x32	40	220-240	50/60	4640	116	3000
PL ECO HLO 600 E 40W 840 U19	4099854187551	595x595x32	40	220-240	50/60	4640	116	4000
PL ECO HLO 600 E 40W 865 U19	4099854187575	595x595x32	40	220-240	50/60	4640	116	6500
PL ECO HLO 600 E 46W 830	4099854187599	595x595x32	46	220-240	50/60	5520	120	3000
PL ECO HLO 600 E 46W 840	4099854187636	595x595x32	46	220-240	50/60	5520	120	4000
PL ECO HLO 600 E 46W 865	4099854187674	595x595x32	46	220-240	50/60	5520	120	6500
PL ECO HLO 600 E 46W 830 U19	4099854187698	595x595x32	46	220-240	50/60	5336	116	3000
PL ECO HLO 600 E 46W 840 U19	4099854187735	595x595x32	46	220-240	50/60	5336	116	4000
PL ECO HLO 600 E 46W 865 U19	4099854187759	595x595x32	46	220-240	50/60	5336	116	6500



	EAN	IP	IK		R _a	° (°C)	PF	
PL ECO HLO 600 E 34W 830	4099854187353	40/20	02	120	>80	0° .. +40°	>0.9	1.55kg
PL ECO HLO 600 E 34W 840	4099854187377	40/20	02	120	>80	0° .. +40°	>0.9	1.55kg
PL ECO HLO 600 E 34W 865	4099854187391	40/20	02	120	>80	0° .. +40°	>0.9	1.55kg
PL ECO HLO 600 E 34W 830 U19	4099854187414	40/20	02	90	>80	0° .. +40°	>0.9	1.64kg
PL ECO HLO 600 E 34W 840 U19	4099854187438	40/20	02	90	>80	0° .. +40°	>0.9	1.64kg
PL ECO HLO 600 E 34W 865 U19	4099854187452	40/20	02	90	>80	0° .. +40°	>0.9	1.64kg
PL ECO HLO 600 E 40W 830	4099854187476	40/20	02	120	>80	0° .. +40°	>0.9	1.55kg
PL ECO HLO 600 E 40W 840	4099854187490	40/20	02	120	>80	0° .. +40°	>0.9	1.55kg
PL ECO HLO 600 E 40W 865	4099854187513	40/20	02	120	>80	0° .. +40°	>0.9	1.55kg
PL ECO HLO 600 E 40W 830 U19	4099854187537	40/20	02	90	>80	0° .. +40°	>0.9	1.64kg
PL ECO HLO 600 E 40W 840 U19	4099854187551	40/20	02	90	>80	0° .. +40°	>0.9	1.64kg
PL ECO HLO 600 E 40W 865 U19	4099854187575	40/20	02	90	>80	0° .. +40°	>0.9	1.64kg
PL ECO HLO 600 E 46W 830	4099854187599	40/20	02	120	>80	0° .. +40°	>0.9	1.59kg
PL ECO HLO 600 E 46W 840	4099854187636	40/20	02	120	>80	0° .. +40°	>0.9	1.59kg
PL ECO HLO 600 E 46W 865	4099854187674	40/20	02	120	>80	0° .. +40°	>0.9	1.59kg
PL ECO HLO 600 E 46W 830 U19	4099854187698	40/20	02	90	>80	0° .. +40°	>0.9	1.66kg
PL ECO HLO 600 E 46W 840 U19	4099854187735	40/20	02	90	>80	0° .. +40°	>0.9	1.66kg
PL ECO HLO 600 E 46W 865 U19	4099854187759	40/20	02	90	>80	0° .. +40°	>0.9	1.66kg

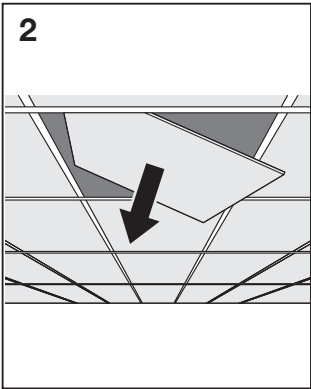
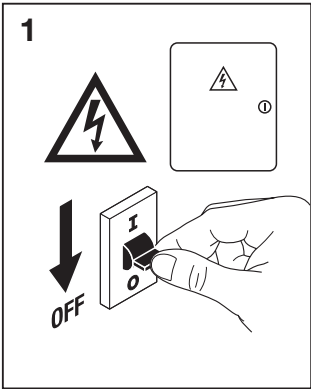
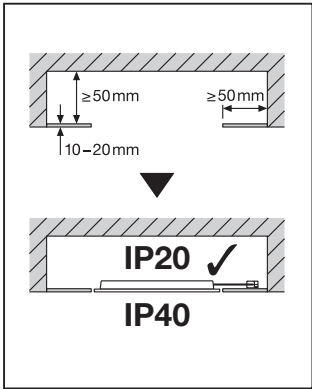

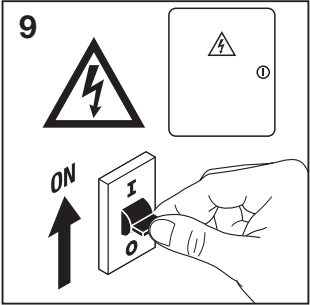
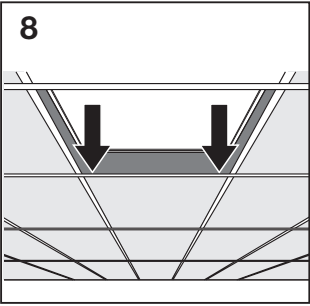
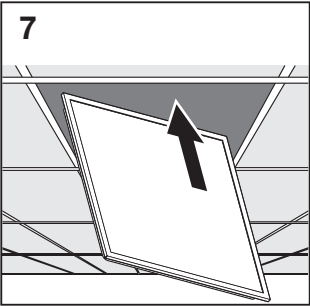
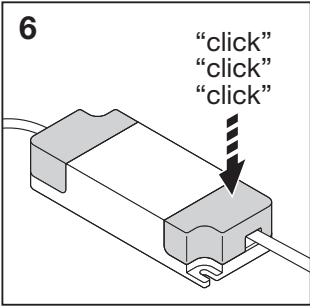
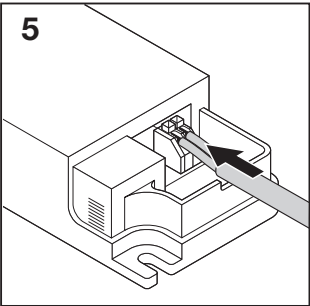
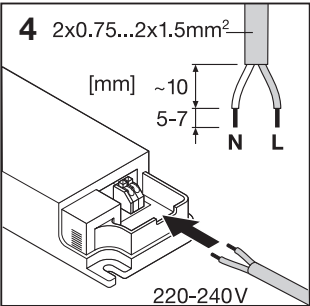
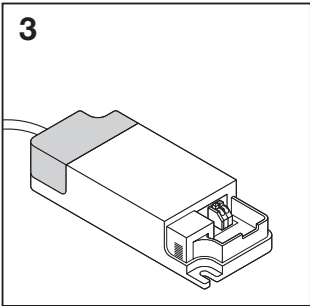

★★

	B16A	C10A	C16A
PL ECO HLO 600 E 34W/40W/46W	n = 12	n = 13	n = 21

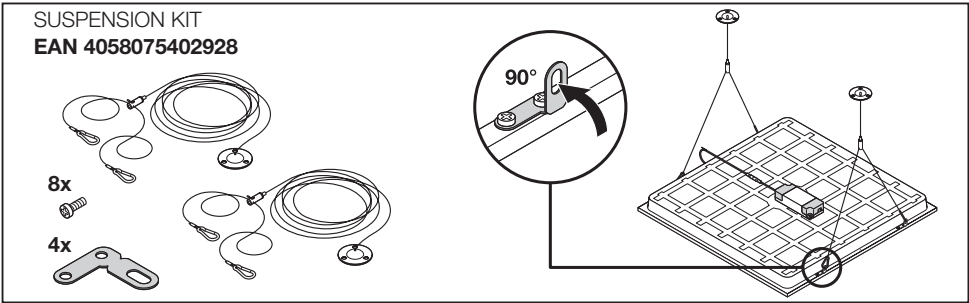

RECESSED
MOUNT CLIPS VALUE
EAN 4058075409859

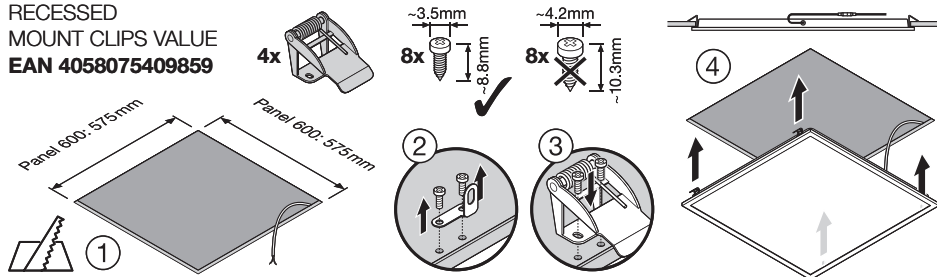

PL 600 SURFACE MOUNT KIT H75
EAN 4058075472914

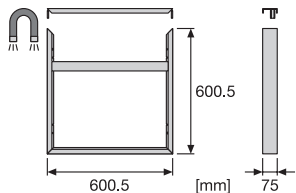

PL 600 SURFACE MOUNT KIT H70 VAL
EAN 4058075402843

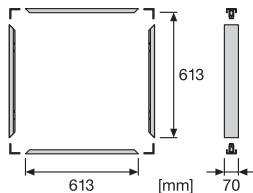

PL 600 RECESSED MOUNT FRAME
EAN 4058075402881

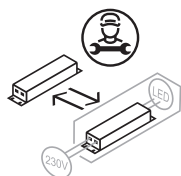
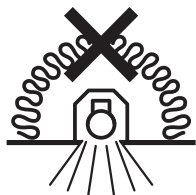
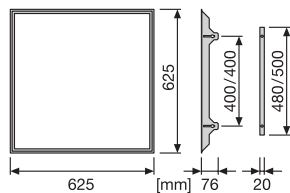

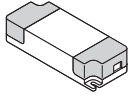
Model		
	Uout	Iout
PL ECO HLO 600 E 34W PL ECO HLO 600 E 34W U19	42V	740mA
PL ECO HLO 600 E 40W PL ECO HLO 600 E 40W U19	42V	850mA
PL ECO HLO 600 E 46W PL ECO HLO 600 E 46W U19	42V	950mA



C10449057
G11259075
29.10.25

LEDVANCE SASU
CQM, 5 rue d'Altorf
67120 Molsheim France
www.ledvance.com

® LEDVANCE Ltd, Sterling House, 810
Mandarin Court, Warrington, Cheshire,
WA1 1GG, United Kingdom

Points de collecte sur www.quefairedemesdechets.fr