

# PHILIPS

## Ledinaire Surface-mounted

### SM060C

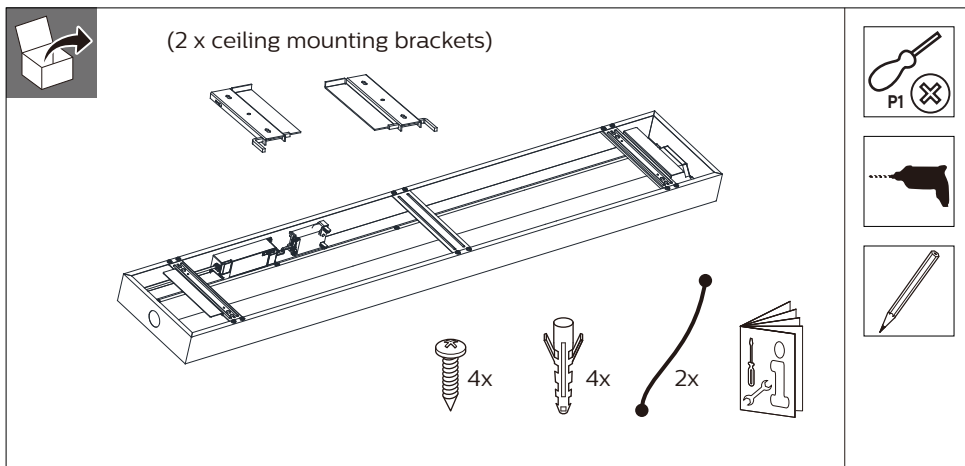

50Hz  
60Hz

220V  
240V



LIFE  
L80  
50k hrs

LIFE  
L70  
75k hrs

IP20

IK03

Max.  
40 °C  
Min.  
10 °C

GLOW  
WIRE  
650 °C



	Luminaire luminous flux (lm)	CCT (K)	Driver	Light source of energy efficiency class	System power (W)	kg
SM060C G2 34_40S/840 PSU W20L120 NOC	3400/4000	4000	PSU	D	28/33	2.87
SM060C G2 34_40S/840 PSU W20L120 OC						

Dimensions in mm

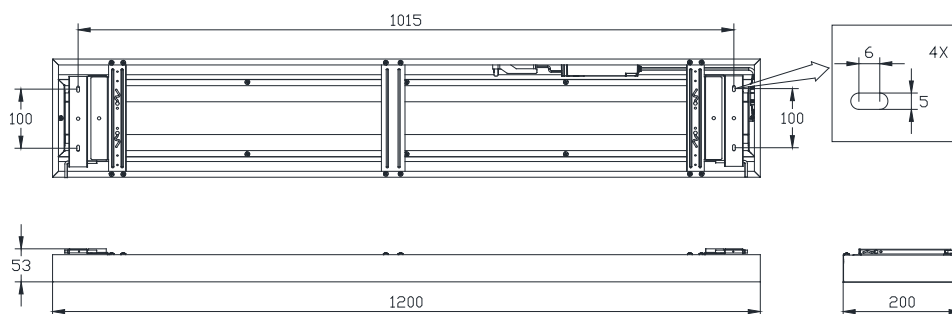

### Inrush current

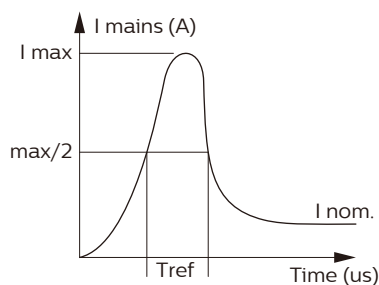

	LED34S	LED40S
Electrical characteristics		
I <sub>max</sub> (A)	17.5	17.5
T <sub>ref</sub> (μs)	120	120
MCB	Luminaires Max.	
B-10A	40	40
B-16A	60	60
C-10A	45	45
C-16A	70	70



- The luminaire shall be installed by a qualified electrician and wired in accordance with the latest IEE electrical regulations or the national requirements.
- The light source contained in this luminaire shall only be replaced by the manufacturer or his service agent or a similar qualified person.
- Luminaire must not be used or stored in corrosive environment where hazardous materials such as Sulphur, Chlorine, Phthalates, etc., are present.
- If the external flexible cable or cord of this luminaire is damaged, it shall be exclusively replaced by the manufacturer or his service agent or a similar qualified person in order to avoid a hazard.



ATTENTION  
OBSERVE PRECAUTIONS  
FOR HANDLING  
ELECTROSTATIC  
SENSITIVE  
DEVICES



## Push-in connectors

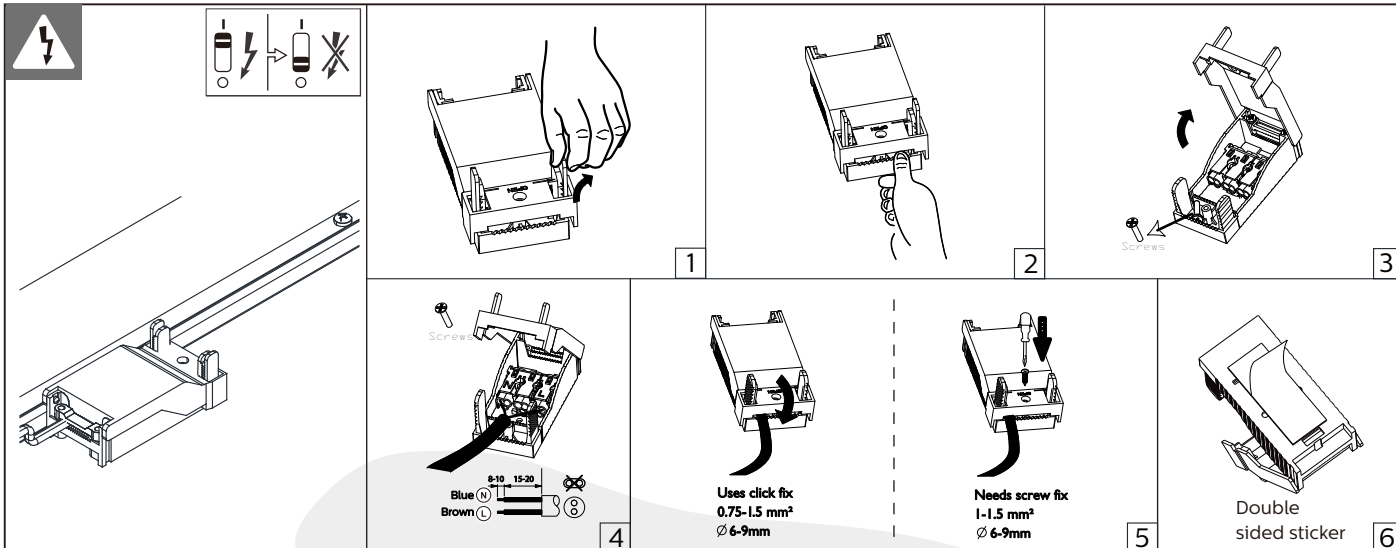

## MultiLumen selection on driver

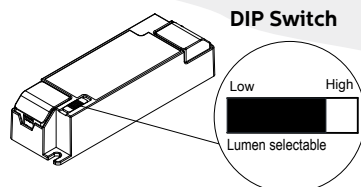

PSU	4.000 K	
PIN	Lumen	Power
Low	3.400 lm*	28 W*
High	4.000 lm	33 W

\* Default setting



## Surface mounted

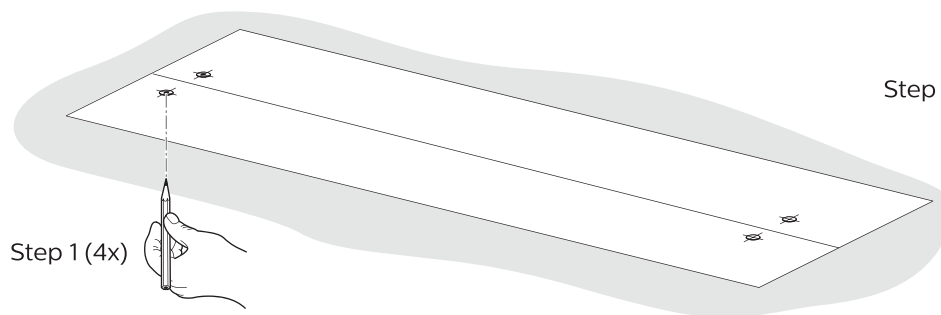

Step 2 (4x)

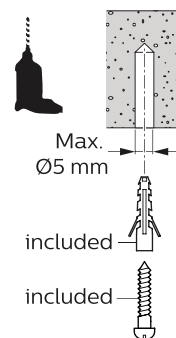

1

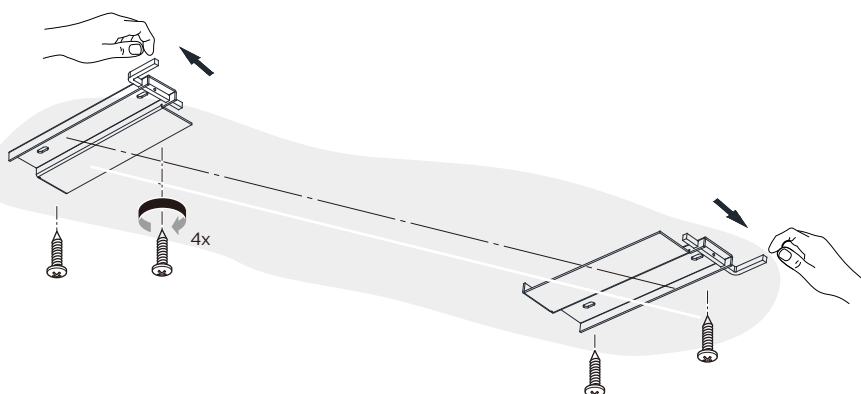

2

3

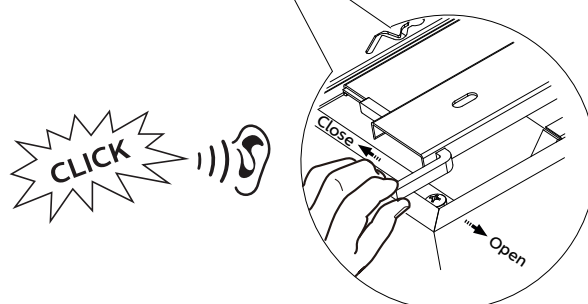
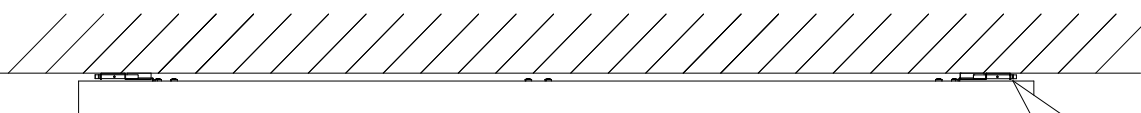
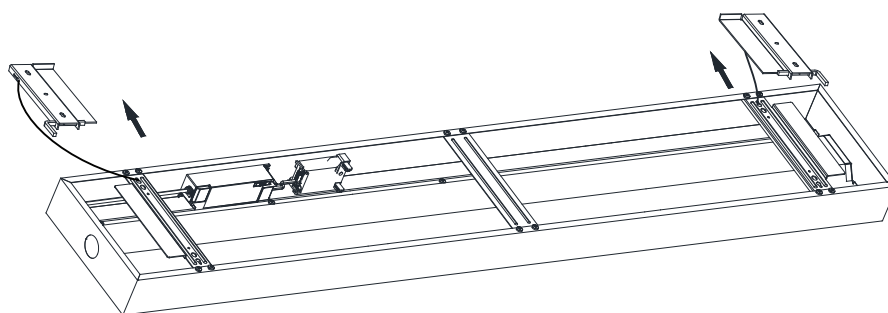
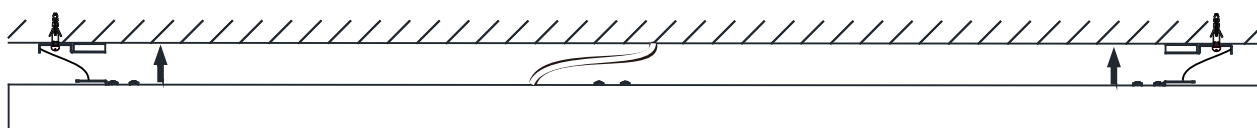
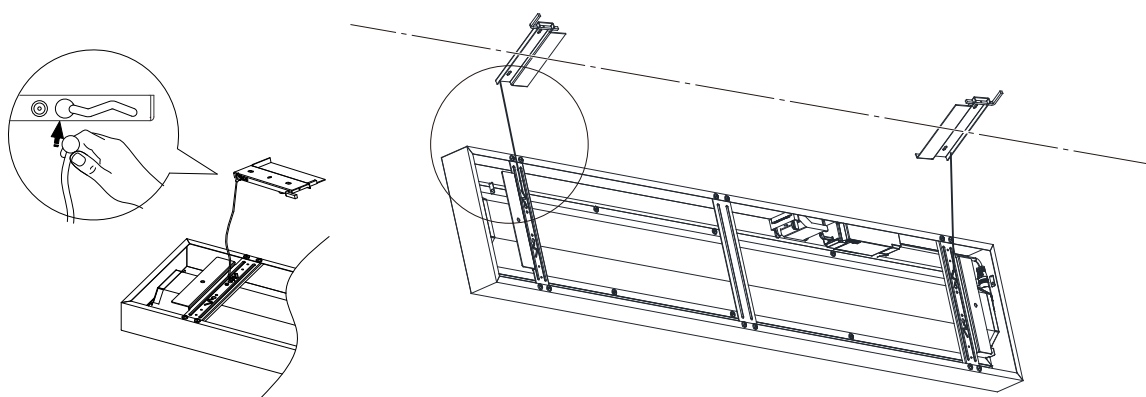

4



# Suspension

Optional with  
911401809487 RC159Z Suspension set SME-3 WH

## PSU

911401809487  
RC159Z Suspension set SME-3 WH

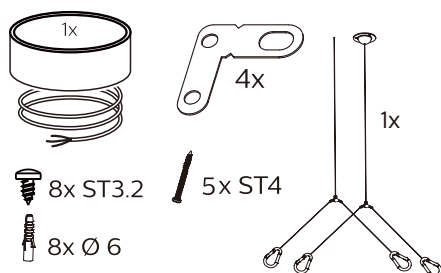

The above accessories need to be purchased separately.

1

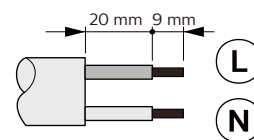
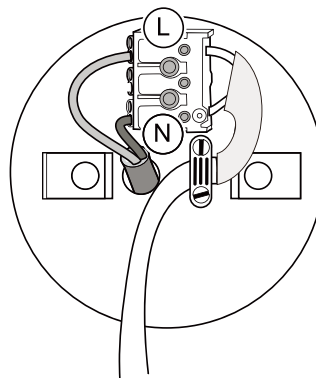
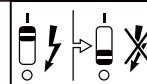

60227 IEC52  
2 x 0.75-1.5 mm<sup>2</sup>  
Ø 6-9 mm

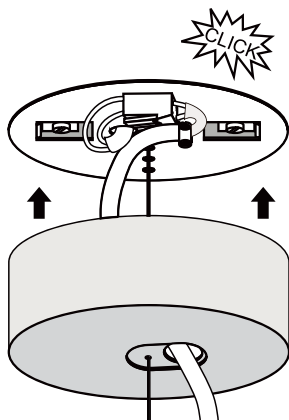

2

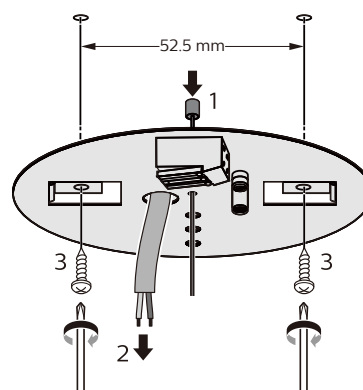

3

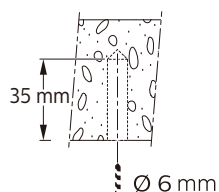

	L(mm)
W20L120	1015

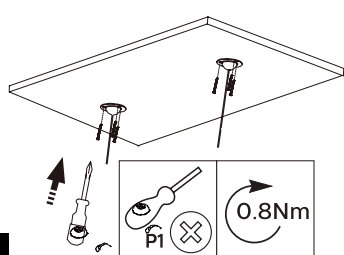
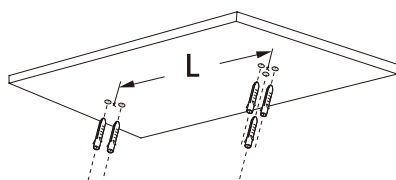

4

