

Lock nuts nickel-plated brass

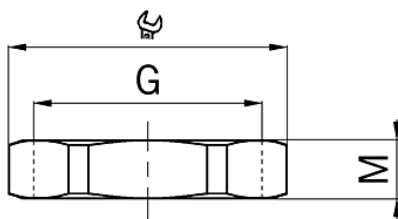

- **Material:** Nickel-plated brass
- **Execution:** Hexagonal design
- **minimal operation temperature:** -40°C
- **maximum operation temperature:** +200°C
- Entry thread metric
- Metric thread
- **Entry thread:** M50x1.5
- **Wrench size:** 55 mm
- **Material thickness:** 5.5
- 1 = Metric coarse-pitch thread

Art. No.: 8000.50

- **E-No.:** 126 363 901
- **Inner packaging:** ST
- **Outer packaging:** 10 ST
- **Individual net weight:** 25,400 G
- **Single volume:** 0,026 L
- **EAN:** 7611614108773
- **ETIM40:** EC000940