

LED DRIVER DIM OUTDOOR PFM

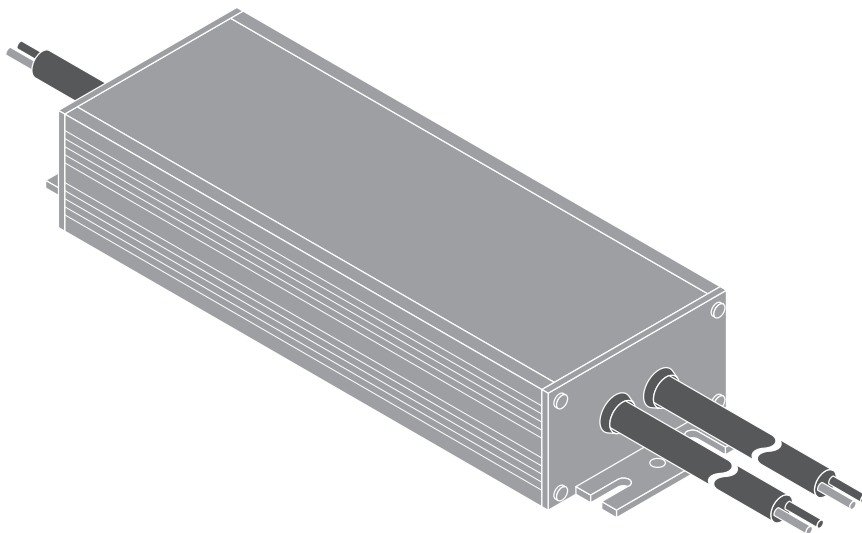

	EAN	l x w x h [mm]	W	IP	θ_{amb} (°C)	VAC	Hz
DR DIM-PFM-20/220-240/24/P	4058075239951	166 x 63 x 38	20	66	-40...+50	220-240 V	50/60 Hz
DR DIM-PFM-40/220-240/24/P	4058075379176	179 x 63 x 38	40	66	-40...+50	220-240 V	50/60 Hz
DR DIM-PFM-60/220-240/24/P	4058075379190	179 x 63 x 38	60	66	-40...+50	220-240 V	50/60 Hz
DR DIM-PFM-100/220-240/24/P	4058075240070	233 x 74 x 42	100	66	-40...+50	220-240 V	50/60 Hz
DR DIM-PFM-150/220-240/24/P	4058075240117	233 x 74 x 42	150	66	-40...+50	220-240 V	50/60 Hz
DR DIM-PFM-250/220-240/24/P	4058075240155	253 x 74 x 42	250	66	-40...+50	220-240 V	50/60 Hz

LED DRIVER DIM OUTDOOR PFM



LEDVANCE
www.ledvance.com
Made in China

DR DIM-PFM-20/220-240/24/P
Constant Voltage
LED POWER SUPPLY

LEDVANCE GmbH
Steinerne Furt 62
86167 Augsburg
Germany

LEDVANCE Ltd, Aquila
House, Delta Crescent,
Westbrook, Warrington,
Wa5 7NR, UK

PRI ~
● L brown
● N blue

P_{rated} [W]	U_N/f_N	I_N [A]	U_{rated} [V]	I_{rated} [A]	t_a [°C]	t_c [°C]	λ
20	220-240 V 50/60 Hz	0.11	24	0.83	-40...+50	65	0.9

CE UK ENEC IP66 SELV DIMMABLE

1-10V
<1mA
● DIM+
● DIM-
● SEC
● LED+
● LED-
LED Only
 U_{out} =24V

picture only
for reference,
valid print on
product¹⁾

LEDVANCE
www.ledvance.com
Made in China

DR DIM-PFM-40/220-240/24/P
Constant Voltage
LED POWER SUPPLY

LEDVANCE GmbH
Steinerne Furt 62
86167 Augsburg
Germany

LEDVANCE Ltd, Aquila
House, Delta Crescent,
Westbrook, Warrington,
Wa5 7NR, UK

PRI ~
● L brown
● N blue

P_{rated} [W]	U_N/f_N	I_N [A]	U_{rated} [V]	I_{rated} [A]	t_a [°C]	t_c [°C]	λ
40	220-240 V 50/60 Hz	0.21	24	1.67	-40...+50	75	0.93

CE UK ENEC IP66 SELV DIMMABLE

1-10V
<1mA
● DIM+
● DIM-
● SEC
● LED+
● LED-
LED Only
 U_{out} =24V

picture only
for reference,
valid print on
product¹⁾

LEDVANCE
www.ledvance.com
Made in China

DR DIM-PFM-60/220-240/24/P
Constant Voltage
LED POWER SUPPLY

LEDVANCE GmbH
Steinerne Furt 62
86167 Augsburg
Germany

LEDVANCE Ltd, Aquila
House, Delta Crescent,
Westbrook, Warrington,
Wa5 7NR, UK

PRI ~
● L brown
● N blue

P_{rated} [W]	U_N/f_N	I_N [A]	U_{rated} [V]	I_{rated} [A]	t_a [°C]	t_c [°C]	λ
60	220-240 V 50/60 Hz	0.31	24	2.5	-40...+50	75	0.95

CE UK ENEC IP66 SELV DIMMABLE

1-10V
<1mA
● DIM+
● DIM-
● SEC
● LED+
● LED-
LED Only
 U_{out} =24V

picture only
for reference,
valid print on
product¹⁾

LEDVANCE
www.ledvance.com
Made in China

DR DIM-PFM-100/220-240/24/P
Constant Voltage
LED POWER SUPPLY

LEDVANCE GmbH
Steinerne Furt 62
86167 Augsburg
Germany

LEDVANCE Ltd, Aquila
House, Delta Crescent,
Westbrook, Warrington,
Wa5 7NR, UK

PRI ~
● L brown
● N blue
● ④ mounting gear

P_{rated} [W]	U_N/f_N	I_N [A]	U_{rated} [V]	I_{rated} [A]	t_a [°C]	t_c [°C]	λ
100	220-240 V 50/60 Hz	0.51	24	4.17	-40...+50	70	0.95

CE UK ENEC IP66 SELV DIMMABLE

1-10V
<1mA
● DIM+
● DIM-
● SEC
● LED+
● LED-
LED Only
 U_{out} =24V

picture only
for reference,
valid print on
product¹⁾

LEDVANCE
www.ledvance.com
Made in China

DR DIM-PFM-150/220-240/24/P
Constant Voltage
LED POWER SUPPLY

LEDVANCE GmbH
Steinerne Furt 62
86167 Augsburg
Germany

LEDVANCE Ltd, Aquila
House, Delta Crescent,
Westbrook, Warrington,
Wa5 7NR, UK

PRI ~
● L brown
● N blue
● ④ mounting gear

P_{rated} [W]	U_N/f_N	I_N [A]	U_{rated} [V]	I_{rated} [A]	t_a [°C]	t_c [°C]	λ
150	220-240 V 50/60 Hz	0.75	24	6.25	-40...+50	75	0.95

CE UK ENEC IP66 SELV DIMMABLE

1-10V
<1mA
● DIM+
● DIM-
● SEC
● LED+
● LED-
LED Only
 U_{out} =24V

picture only
for reference,
valid print on
product¹⁾

LEDVANCE
www.ledvance.com
Made in China

DR DIM-PFM-250/220-240/24/P
Constant Voltage
LED POWER SUPPLY

LEDVANCE GmbH
Steinerne Furt 62
86167 Augsburg
Germany

LEDVANCE Ltd, Aquila
House, Delta Crescent,
Westbrook, Warrington,
Wa5 7NR, UK

PRI ~
● L brown
● N blue
● ④ mounting gear

P_{rated} [W]	U_N/f_N	I_N [A]	U_{rated} [V]	I_{rated} [A]	t_a [°C]	t_c [°C]	λ
250	220-240 V 50/60 Hz	1.21	24	10.42	-40...+50	85	0.95

CE UK ENEC IP66 SELV DIMMABLE

1-10V
<1mA
● DIM+
● DIM-
● SEC
● LED+
● LED-
LED Only
 U_{out} =24V

picture only
for reference,
valid print on
product¹⁾

TECHNICAL TABLE

GTIN10	GTIN40	PRODUCT DESCRIPTION	Input Voltage AC (V)	Inrush current (A)	Max. ECG no. on circuit breaker 10A (B)	Max. ECG no. on circuit breaker 16A (B)	Max. ECG no. on circuit breaker 25A (B)	T _H (μs)
4058075239951	4058075239968	DR DIM-PFM-20/220-240/24/P 10X1 LEDV	198...264	40.3	14	18	29	5.4
4058075379176	4058075240001	DR DIM-PFM-40/220-240/24/P 10X1 LEDV	198...264	38.1	15	19	30	5.6
4058075379190	4058075240025	DR DIM-PFM-60/220-240/24/P 10X1 LEDV	198...264	35.2	17	21	33	4.6
4058075240070	4058075240087	DR DIM-PFM-100/220-240/24/P 10X1 LEDV	198...264	46.1	13	16	25	16
4058075240117	4058075240124	DR DIM-PFM-150/220-240/24/P 10X1 LEDV	198...264	48.6	10	15	24	17
4058075240155	4058075240162	DR DIM-PFM-250/220-240/24/P 10X1 LEDV	198...264	66.6	6	10	16	27

WIRE DIAGRAM – SINGLE CONNECTION

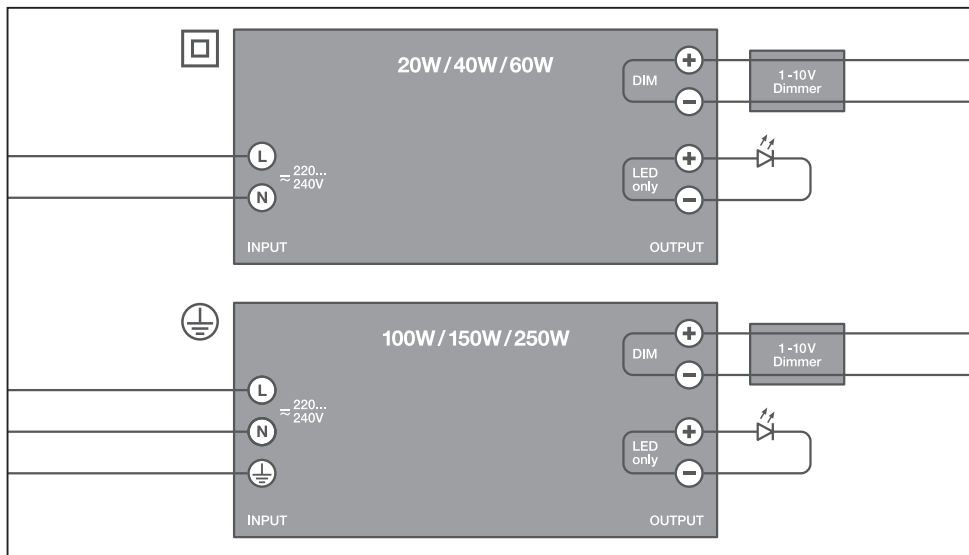

(B) Installing and operating information (24V LED driver): Connect only LED 24V load type. When present, protective earth connection is mandatory for safety and EMI reasons. The ground connection shall be done with the input cable.

Technical support: www.ledvance.com

1) picture only for reference, valid print on product

(D) Installations- und Betriebsanweisung (24V LED-Treiber): Nur an LED-Module 24V anschließen. Ist ein Schutzleiter vorhanden, muss dieser aus Sicherheitsgründen und zum Schutz vor elektromagnetischer Störung geerdet werden. Die Erdung erfolgt über das Eingangskabel.

Technische Unterstützung: www.ledvance.com,

Kundenservicecenter: kundenservice@ledvance.com,

Deutschland: Tel.: +49 89 780673-660, Fax: +49 89 780670-665,

Österreich: Tel.: +43 1 68068 118 oder 126, Fax: +43 1 68068 7

1) Foto dient nur als Referenz, gültiger Druck auf dem Produkt

(E) Informations pour l'installation et le fonctionnement (Transformateur LED 24 V) : Raccorder uniquement des LED prévues pour une tension de 24 V. Si disponible, le conducteur de protection du dispositif de mise à la terre doit impérativement être raccorder pour des raisons de sécurité et de respect des prescriptions en matière de CEM. La mise à la terre doit être effectuée avec le câble d'entrée.

Support technique : www.ledvance.com

1) image non contractuelle, se référer aux inscriptions sur le produit

(I) Informazioni su installazione e funzionamento (Driver LED 24V): Collegare solo LED con carico da 24V. Se presente, il collegamento di terra di protezione è obbligatorio per motivi di sicurezza e di interferenza elettromagnetica. Il collegamento di terra deve essere effettuato con il cavo di ingresso.

Supporto tecnico: www.ledvance.com

1) immagine solo come riferimento, stampa valida sul prodotto

(E) Indicaciones de instalación y funcionamiento (LED driver de 24 V): Conecte únicamente un tipo de carga de LED de 24 V. Si está disponible, la conexión a tierra de protección es obligatoria por motivos de seguridad y para evitar interferencias electromagnéticas. La conexión a tierra debe realizarse con el cable de entrada.

Soporte técnico: www.ledvance.com

1) La imagen solo es de referencia; la impresión válida se encuentra en el producto

(P) Informação de instalação e funcionamento (Driver de LED de 24V): Conectar apenas o tipo de carga de LED de 24V. Quando presente, a ligação à terra de proteção é obrigatória por motivos de segurança e IEM. A ligação à terra tem que ser efetuada com o cabo de alimentação.

Apoio Técnico: www.ledvance.com

1) imagem apenas para referência, estampa válida no produto

