



	EAN	Φ x h [mm]	W	V <sub>AC</sub>	Hz	Im	Im/W	K
CEILING ROUND 210 12W 830 IP44	4099854105777	210x62	12	220-240	50/60	900	75	3000
CEILING ROUND 210 12W 840 IP44	4099854105791	210x62	12	220-240	50/60	900	75	4000
CEILING ROUND 210 12W 865 IP44	4099854105814	210x62	12	220-240	50/60	900	75	6500
CEILING ROUND 255 18W 830 IP44	4099854105838	255x70	18	220-240	50/60	1350	75	3000
CEILING ROUND 255 18W 840 IP44	4099854105852	255x70	18	220-240	50/60	1350	75	4000
CEILING ROUND 255 18W 865 IP44	4099854105876	255x70	18	220-240	50/60	1350	75	6500
CEILING ROUND 325 24W 830 IP44	4099854105890	325x72	24	220-240	50/60	1800	75	3000
CEILING ROUND 325 24W 840 IP44	4099854105913	325x72	24	220-240	50/60	1800	75	4000
CEILING ROUND 325 24W 865 IP44	4099854105937	325x72	24	220-240	50/60	1800	75	6500
CEILING ROUND 210 SEN 12W 830 IP44	4099854105951	210x62	12	220-240	50/60	900	75	3000
CEILING ROUND 210 SEN 12W 840 IP44	4099854105975	210x62	12	220-240	50/60	900	75	4000
CEILING ROUND 210 SEN 12W 865 IP44	4099854105999	210x62	12	220-240	50/60	900	75	6500
CEILING ROUND 255 SEN 18W 830 IP44	4099854106019	255x70	18	220-240	50/60	1350	75	3000
CEILING ROUND 255 SEN 18W 840 IP44	4099854106033	255x70	18	220-240	50/60	1350	75	4000
CEILING ROUND 255 SEN 18W 865 IP44	4099854106057	255x70	18	220-240	50/60	1350	75	6500
CEILING ROUND 325 SEN 24W 830 IP44	4099854106071	325x72	24	220-240	50/60	1800	75	3000
CEILING ROUND 325 SEN 24W 840 IP44	4099854106095	325x72	24	220-240	50/60	1800	75	4000
CEILING ROUND 325 SEN 24W 865 IP44	4099854106118	325x72	24	220-240	50/60	1800	75	6500

**NOT FOR PRINT PRODUCTION!**

**WARNING:**

This PDF file is for reference only and not to be used for the creation of production art.

Colour printouts and screen displays should not be used for colour approval as colours may vary from device to device. The colour values for this file are defined in Pantone (PMS), HKS, or in process colours (CMYK).

For obtaining hard-copies in actual size (1:1) you need to enter the proper settings in your printer options.

**本品不可印刷生产**

**警告:**

本PDF文档仅作为参照文件，不能将本文档用于印刷或者制作菲林。本文档的彩色打印版本或其电脑屏幕上显示的彩色，不可用于最终的彩色呈现。因为硬件设备的差异，可能造成颜色的偏差。最终正式的彩色请由色板卡片PMS、HKS或者CMYK（青红黄黑）所定义。若本文档的打印件要获取1:1的原始尺寸，须在打印时作出相应的设置。



NOT FOR PRINT  
PRODUCTION!

WARNING:

This PDF file is for reference only and not to be used for the creation of production art.  
Colour printouts and screen displays should not be used for colour approval as colours may vary from device to device. The colour values for this file are defined in either Pantone (PMS), HKS, or in process colours (CMYK). For obtaining hard-copies in actual size (1:1) you need to enter the proper settings in your printer options.

本品不可印刷生产

警告:

本PDF文档仅作为参照文件，不能将本文档用于印刷生产或者制作菲林。本文档的彩色打印版本或其在电脑屏幕中显示的彩色，不可用于最终的色彩参照。因为硬件或设备的差异，可能造成色彩的偏差。最终正式的色彩请遵照由色板卡片PMS、HKS或者CMYK(青红黄黑)所定义的色彩。若本文档的打印件要获取1:1的原始尺寸，须在打印选项中作出相应的设置。



LEDVANCE

CEILING ROUND



	EAN	IP	IK	∠	R <sub>a</sub>	°(°C)	DF	人
CEILING ROUND 210 12W 830 IP44	4099854105777	44	03	120°	>80	-20...+40	>0.7	0,24 kg
CEILING ROUND 210 12W 840 IP44	4099854105791	44	03	120°	>80	-20...+40	>0.7	0,24 kg
CEILING ROUND 210 12W 865 IP44	4099854105814	44	03	120°	>80	-20...+40	>0.7	0,24 kg
CEILING ROUND 255 18W 830 IP44	4099854105838	44	03	120°	>80	-20...+40	>0.7	0,32 kg
CEILING ROUND 255 18W 840 IP44	4099854105852	44	03	120°	>80	-20...+40	>0.7	0,32 kg
CEILING ROUND 255 18W 865 IP44	4099854105876	44	03	120°	>80	-20...+40	>0.7	0,32 kg
CEILING ROUND 325 24W 830 IP44	4099854105890	44	03	120°	>80	-20...+40	>0.7	0,48 kg
CEILING ROUND 325 24W 840 IP44	4099854105913	44	03	120°	>80	-20...+40	>0.7	0,48 kg
CEILING ROUND 325 24W 865 IP44	4099854105937	44	03	120°	>80	-20...+40	>0.7	0,48 kg
CEILING ROUND 210 SEN 12W 830 IP44	4099854105951	44	03	120°	>80	-20...+40	>0.7	0,25 kg
CEILING ROUND 210 SEN 12W 840 IP44	4099854105975	44	03	120°	>80	-20...+40	>0.7	0,25 kg
CEILING ROUND 210 SEN 12W 865 IP44	4099854105999	44	03	120°	>80	-20...+40	>0.7	0,25 kg
CEILING ROUND 255 SEN 18W 830 IP44	4099854106019	44	03	120°	>80	-20...+40	>0.7	0,33 kg
CEILING ROUND 255 SEN 18W 840 IP44	4099854106033	44	03	120°	>80	-20...+40	>0.7	0,33 kg
CEILING ROUND 255 SEN 18W 865 IP44	4099854106057	44	03	120°	>80	-20...+40	>0.7	0,33 kg
CEILING ROUND 325 SEN 24W 830 IP44	4099854106071	44	03	120°	>80	-20...+40	>0.7	0,49 kg
CEILING ROUND 325 SEN 24W 840 IP44	4099854106095	44	03	120°	>80	-20...+40	>0.7	0,49 kg
CEILING ROUND 325 SEN 24W 865 IP44	4099854106118	44	03	120°	>80	-20...+40	>0.7	0,49 kg

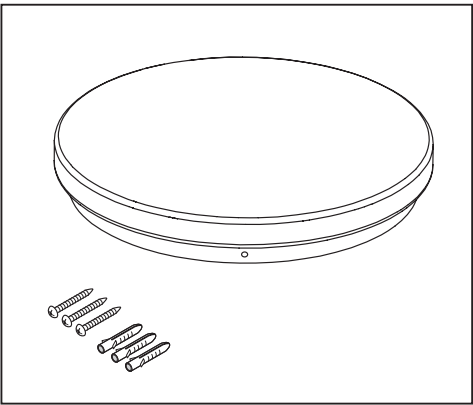

2

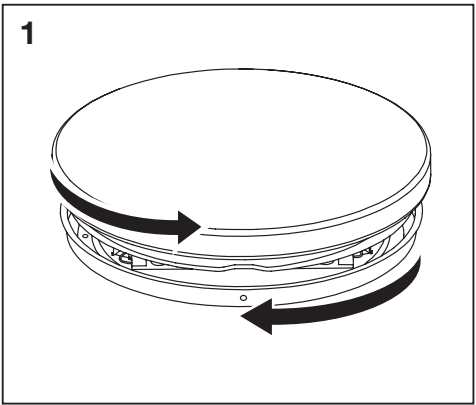

1



## CEILING ROUND

**NOT FOR PRINT  
PRODUCTION!****WARNING:**

This PDF file is for reference only and not to be used for the creation of production art.  
Colour printouts and screen displays should not be used for colour approval as colours may vary from device to device. The colour values for this file are defined in Pantone (PMS), HKS, or in process colours (CMYK). For obtaining hard-copies in actual size (1:1) you must enter the proper settings in your printer options.

**本品不可印刷生产****警告:**

本PDF文档仅作为参考文件，不能将本文档用于印刷或者制作菲林。本文档的彩色打印版本或其在电脑屏中显示的色彩，不可用于最终的色彩参照。因为硬件设备的差异，可能造成色彩的偏差。最终正式的色彩请由色板卡片PMS、HKS或者CMYK(青红黄黑)所定义的。若本文档的打印件要获取1:1的原始尺寸，须在打印时作出相应的设置。

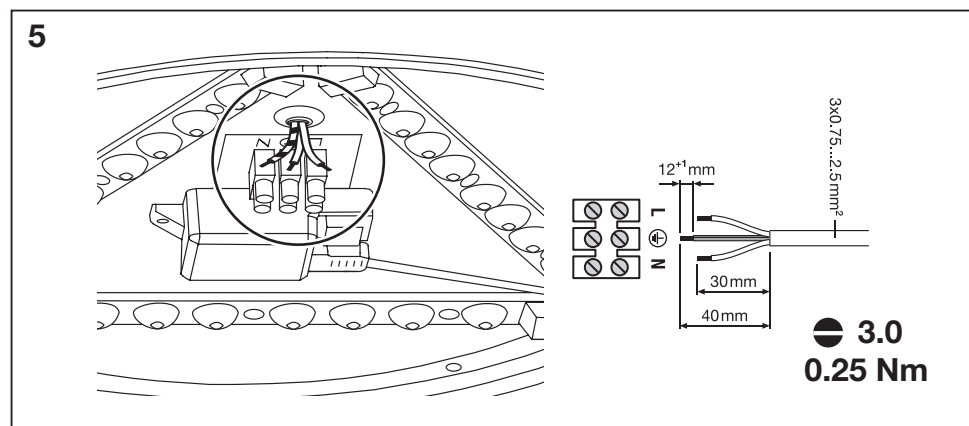
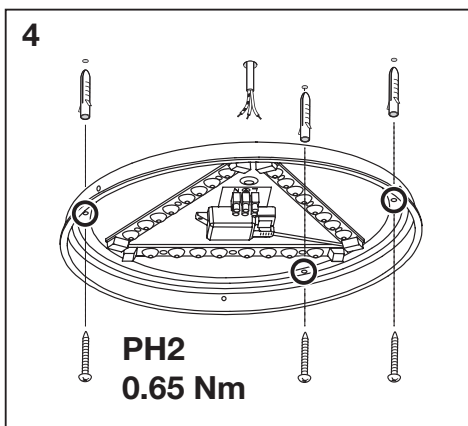
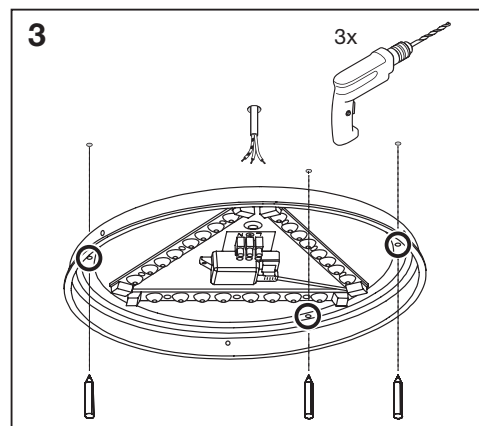
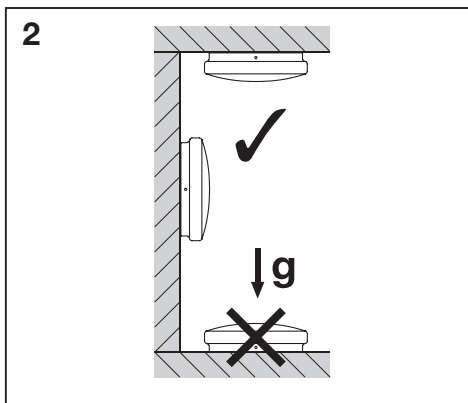
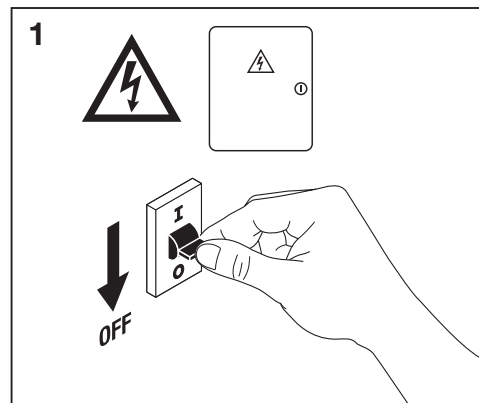

**NOT FOR PRINT PRODUCTION!**

**WARNING:**

This PDF file is for reference only and not to be used for the creation of production art.  
Colour printouts and screen displays should not be used for colour approval as colours may vary from device to device. The colour values for this file are defined in either Pantone (PMS), HKS, or in process colours (CMYK).  
For obtaining hard-copies in actual size (1:1) you need to enter the proper settings in your printer options.

**本品不可印刷生产**

**警告:**

本PDF文档仅作为参考文件，不能将本文档用于印刷生产或者制作作品。本文档的彩色打印版本或其存在电脑屏幕上显示的彩色，不可用于最终的彩色参照。因为硬件或设备的差异，可能造成色彩的偏差。最终正式的色彩请遵照由色板卡片PMS、HKS或者CMYK（青红黄黑）所定义的色彩。若本文档的打印件要获取1:1的原始尺寸，须在打印选项中作出相应的设置。

**LEDVANCE**

## CEILING ROUND



**6**

**Sound threshold**

1		2		3		4	
A1	ON	A2	30-50 dB	A3	ON	A4	15-35 lux
B1	Disable	B2	60-80 dB	B3	Disable	B4	50-70 lux

**Daylight threshold**

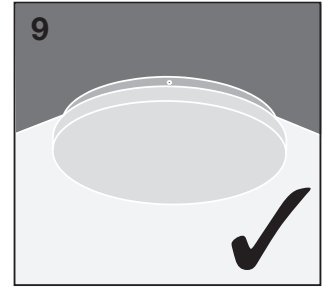
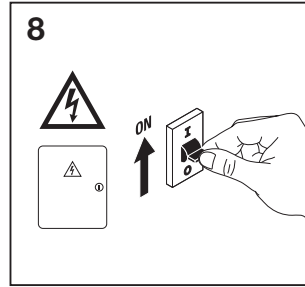
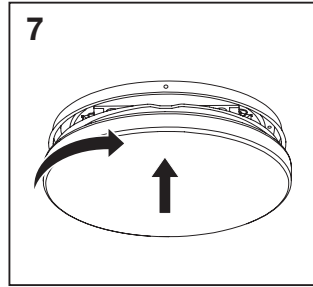

	Inrush current [A]	Th50 [µs]	B10	B16	B32	C10	C16	C32
Ceiling Round IP44 210mm 12W	7.4	184	45	51	80	47	75	118
Ceiling Round IP44 210mm 18W	7.4	240	35	45	70	40	64	101
Ceiling Round IP44 210mm 24W	7.8	344	20	26	41	25	41	64
Ceiling Round SEN IP44 210mm 12W	6.8	128	70	89	139	70	112	176
Ceiling Round SEN IP44 210mm 18W	7.8	320	23	29	45	28	46	72
Ceiling Round SEN IP44 210mm 24W	7.8	336	20	26	41	28	41	64

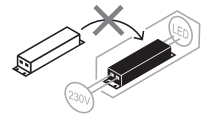
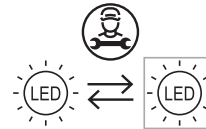

**CEAC**  **UKCA IP44**



FR

**Cet appareil et ses accessoires se recyclent**

## À DÉPOSER

**À DÉPOSER**

**EN MAGASIN**

## EN DÉCHÈTERIE

Points de collecte sur [www.quefairedemesdechets.fr](http://www.quefairedemesdechets.fr)

C10449057  
G11166468

15.04.23



© LEDVANCE Ltd, Aquila House  
Delta Crescent, Westbrook, Warrington  
WA5 7NR, United Kingdom

LEDVANCE GmbH  
Steinerne Furt 62  
86167 Augsburg, Germany  
**[www.ledvance.com](http://www.ledvance.com)**

