

12-module Floor Boxes

Cat. Nos: 0 881 70/71/72

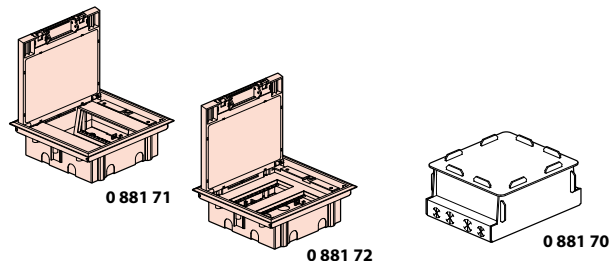

CONTENTS

Page

1. Use	1
2. Range	1
3. Dimensions	2
4. Installation	3
5. Specific installation for ip24 performance ..	5
6. Technical characteristics	6
7. Material characteristics	6

1. USE

The 12-module floor boxes allow:

- the distribution of power and low-voltage supply to the various workstations through the floor,
- the installation of different types of floor coverings such as carpet or vinyl up to 8 mm thick,
- the supply of their devices using ICTA conduits (20 mm Ø for both versions, 23 mm Ø and 25 mm Ø for the horizontal-mount version), perfect separation of cables,
- and the protection of cords thanks to a rigid cable outlet.

They are also the ideal solution for concrete screeds or raised floors in renovation, particularly the vertical-mount version (from a minimum height of 75 mm in raised floors and 80 mm in concrete).

2. RANGE

■ 2.1 12- module floor boxes

Wiring devices installation

in horizontal position

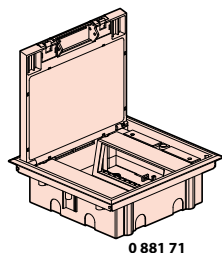

in vertical position

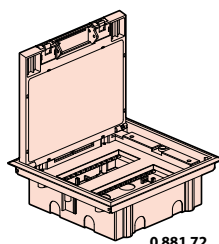

Height adjustable from 75 mm to 110 mm.

To be equipped with 12-module Mosaic / Arteor / Myrius devices.
Supplied with a removable cover for 8 mm-thick carpet or vinyl flooring.
Easy opening using a large handle.
Certified according to IEC 60670-1 and IEC 60670-23 standards.
Grey RAL 7031.

Removable lid : can be removed for an easy installation of wiring devices inside the box ...

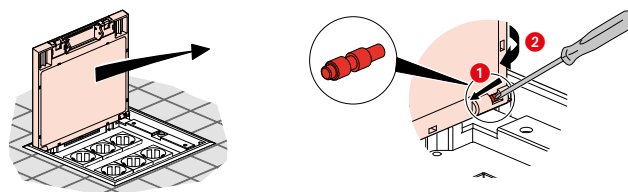

... and can be rotated 180° to modify the direction of the cable exit

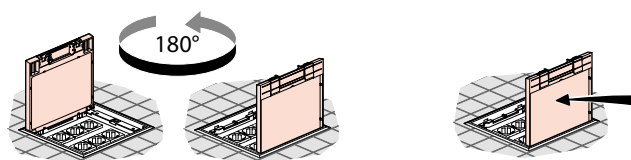

■ 2.2 Screed floor backbox

Material : Polypropylène alvéolaire

This under-floor backbox for concrete floor allows pouring the concrete over ICTA flexible conduits before installing floor boxes.
The backbox is flat packed and has to be folded during installation.

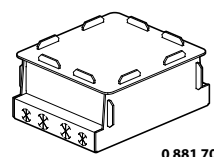

0 881 70

3. DIMENSIONS

■ 3.1 12-module floor boxes cat. nos 0 881 71/72

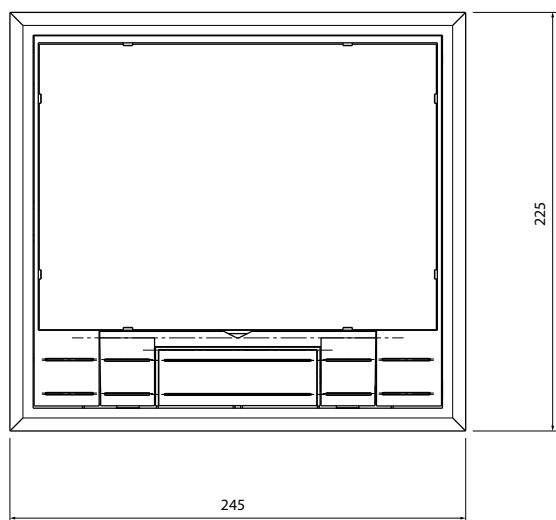
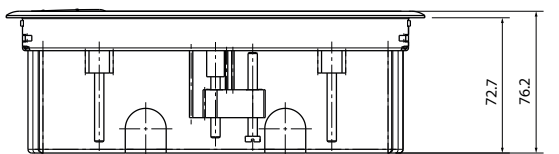

8 mm thick available space

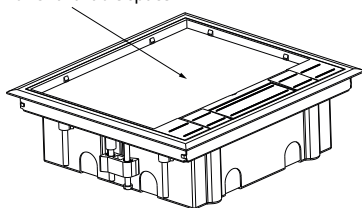

■ 3.2 Screed floor back box cat. no 0 881 70

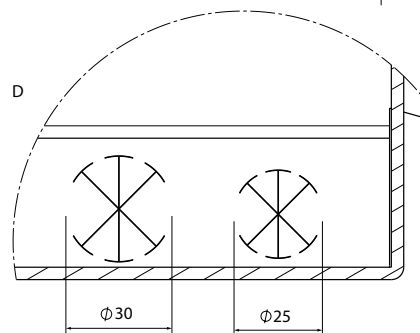
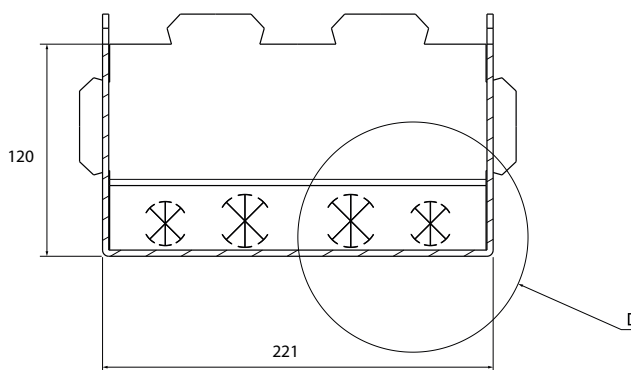
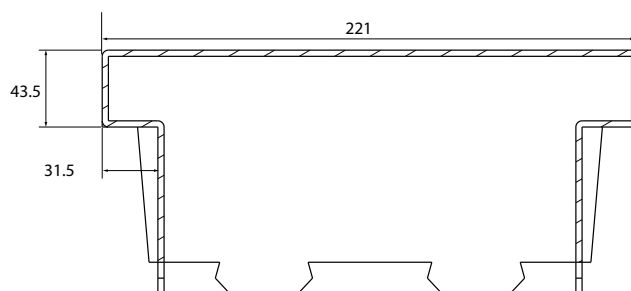
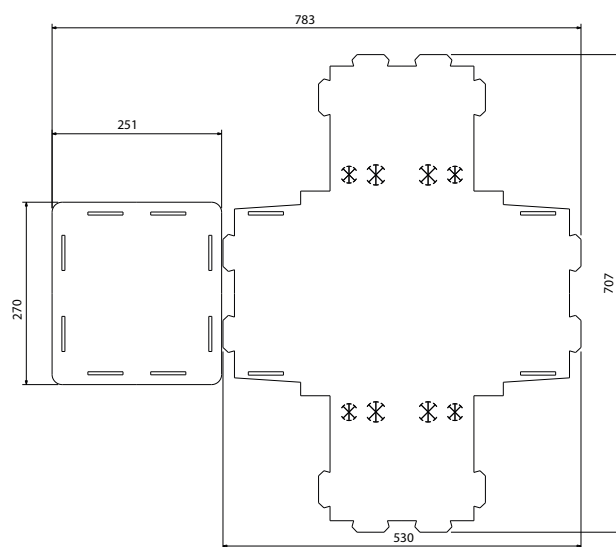

4. INSTALLATION

■ 4.1 in a raised floor

Cut the raised floor.

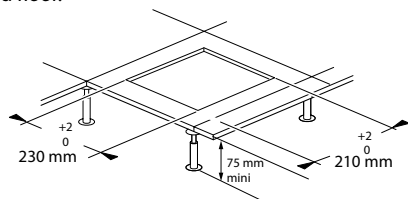

Measure the depth H of the raised floor.

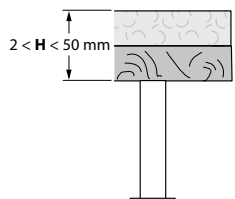

Unscrew A and B to achieve at least H + 5 mm between the lid base and the tip of screw B.

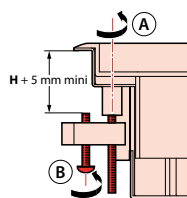

Place the fixing brackets on each side along the box (with the pointed end facing the box).

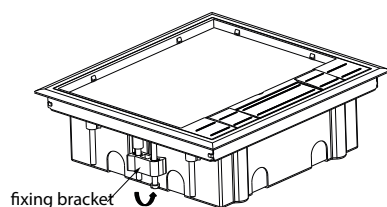

Next, insert the floor box into the raised floor and tighten screw C to fasten it. The minimum required installation height is 75 mm.

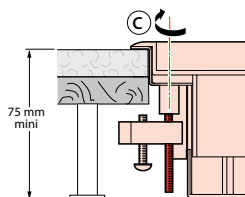

Wiring devices installation

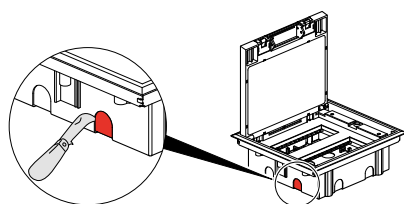

Break the isolator knockouts to allow cables or conduits to pass through.

4.1.1 Wiring devices installation in horizontal position with floor box cat. no 0 881 72

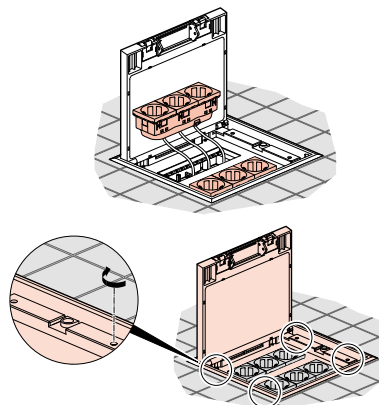

Adjust the height of the wiring devices by tightening the 4 screws.

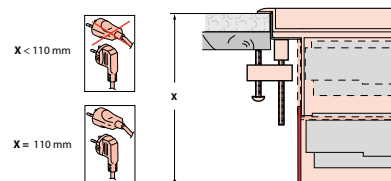
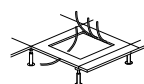

4.1.2 Wiring devices installation in vertical position with floor box cat. no 0 881 71

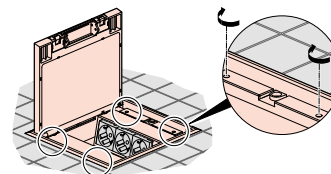
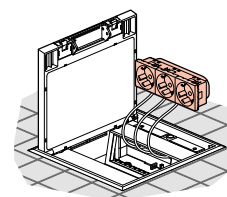

Adjust the height of the wiring devices by tightening the 4 screws.

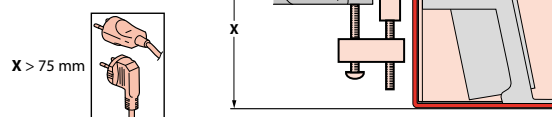
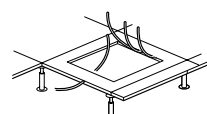

4. INSTALLATION (CONT.)

■ 4.2 in concrete with screed floor backbox cat. no 0 881 70

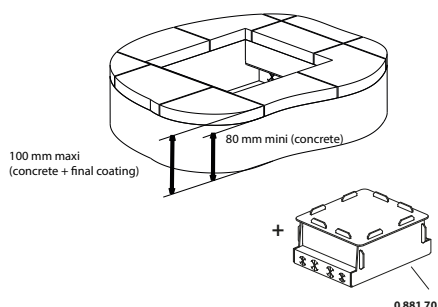

- Fold the screed backbox.

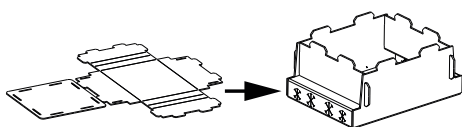

- Fix the backbox on the slab

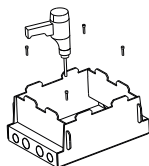

- Insert the conduits (use a tool to bend them)

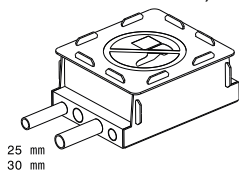

Do not step on the flush backbox.

- Pour the concrete : 80 mm mini

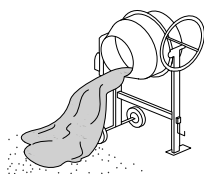

(and make sure to keep in mind the 100 mm maximum, including the final floor covering)

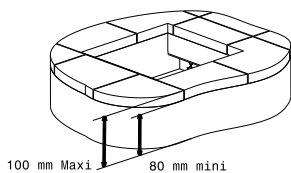

- Cut once concrete is dry

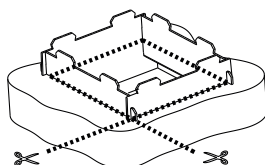

Remove the screws (1) of the 2 fixing brackets on both sides of the box and insert the floor box into the concrete screed and tighten (2) in order to secure the floor box

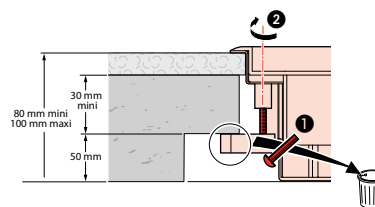

Wiring devices installation

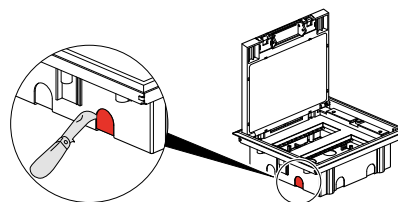

Break the isolator knockouts to allow cables or conduits to pass through.

4.2.1 Floor box cat. no 0 881 72 for wiring devices in horizontal position

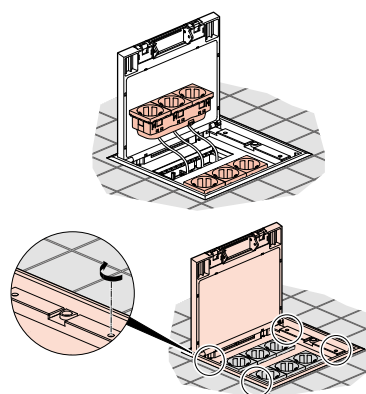

Adjust the height of the wiring devices by tightening the 4 screws.

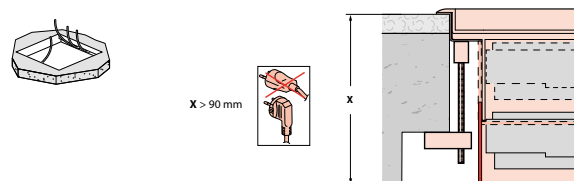

4. INSTALLATION (CONT.)

■ 4.2 in concrete with screed floor backbox cat. no 0 881 70 (cont.)

4.2.2 Floor box for wiring devices in vertical position cat. no 0 881 71

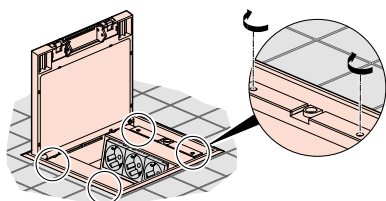
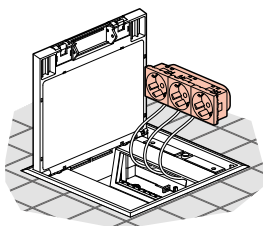

Adjust the height of the wiring devices by tightening the 4 screws.

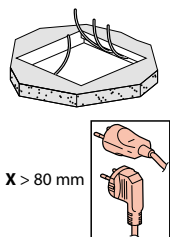
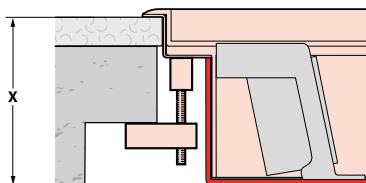
 $X > 80 \text{ mm}$ 

■ 4.3 Finishing plates

Lid is equipped with a metal plate providing its rigidity.
Don't install tile inside this lid but carpet or vinyl flooring up to 8 mm thick.

Cut the carpet or vinyl flooring according to the dimensions below :

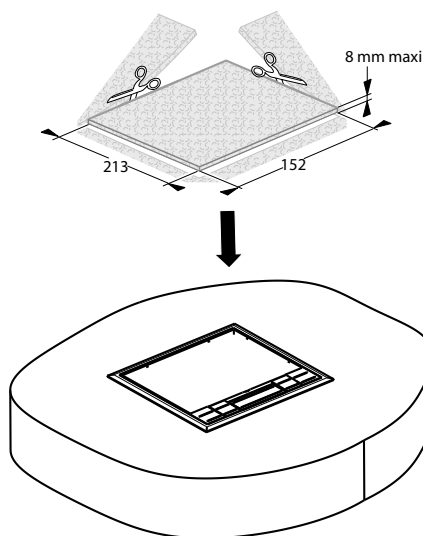

5. SPECIFIC INSTALLATION FOR IP24 PERFORMANCE

For IP24 performance of the device supports

■ 5.1 in a concrete screed for the two floor boxes (cat. nos. 0 881 71/72)

Provide an evacuation drain before pouring the concrete screed.

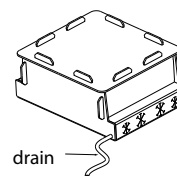

drain

■ 5.2 only for cat. no 0 881 72 in any type of floor

Before installing the floor box into the floor, create a 4-degree tilt toward the cable outlet: 11 mm lower on that side compared with the opposite side, by adjusting the two screws as shown in the illustration below."

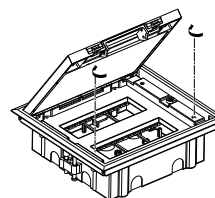

The minimum depth required in the floor then becomes 83 mm (final coating included).

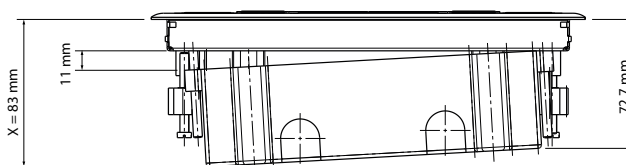
 X : minimum final floor height required

The compatibility with the user types of plugs becomes:

- in raised floor

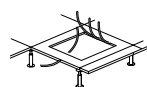
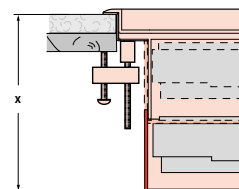
 $83 < X < 110 \text{ mm}$  $X = 110 \text{ mm}$ x 2 max
(côté sortie
de câbles)

- in screed floor

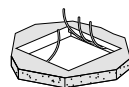
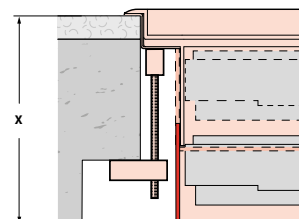
 $X > 101 \text{ mm}$ 

6. TECHNICAL CHARACTERISTICS

Classification of the 12-module Floor boxes according to the IEC 60670-1 et IEC 60670-23 standard :

7.1 The nature of their material	7.1.3	Composite
7.2 The method of installation	7.2.1.3	Flush, semi-flush or embedded in non-combustible floors
	7.2.3.1	Placement suitable for installation into concrete during the casting process
	7.102.1	Floor boxes or enclosures installed in floor subjected to dry treatment
7.3 The type of inlets (outlets)	7.3.7	Without inlets. Inlet openings will be made during installation
7.4 The clamping means	7.4.4	Without clamping means
7.5 The minimum and maximum temperatures during installation	7.5.1	- 5 °C to + 60 °C
7.6 The maximum temperature during the casting process	7.6.1	+60°C
13 Protection against ingress of solid objects & against harmful ingress of water	13.2 & 13.3	IP20
15.101 Resistance to vertical load through a small surface		500 N

Protection class :

Protection to IP20 with the cover closed (possible up to IP24 : see paragraph "Installation specifics for IP24 performance")

Resistance to impacts: IK 08 with the cover closed

Self-extinguishing : + 650° C / 30 s for parts made of insulating materials

The inlets of conduits or cables are pre-cutting for a easier installation

Safety:

Check that the system is earthed

Cleaning:

Do not use abrasive products or detergent

7. MATERIAL CHARACTERISTICS

Floor boxes material:

- * Plastic materials : ABS
- * Galvanised steel (Z140)
- * Galvanised steel (Z275)

Screed backbox:

- * Plastic materials : PP alveolar